

SPINDLE ADAPTER KIT 05536

For use on Hougen Drill Models HMD904 & HMD908

The 05536 Adapter Kit is to be used to install a Jacobs Chuck onto a "Hex Drive" spindle. The Hex Drive Assembly will have 2) 1/4-28 X 3/8 set screws (Fig.1) at the top of the arbor body. If your HMD904 or HMD908 does not have these set screws the Arbor Assembly is a "Threaded Spindle and will require the use of Spindle Adapter 01829.

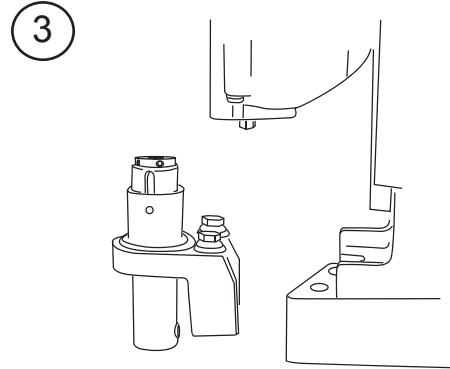
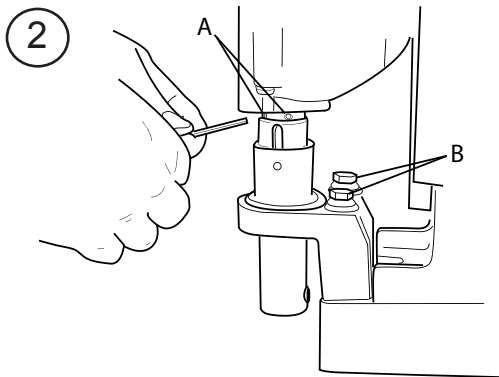
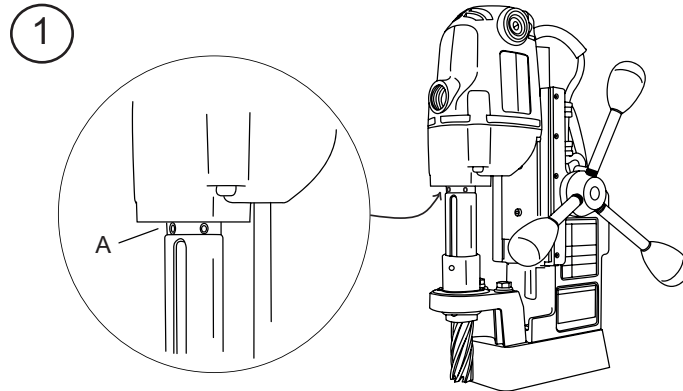

Remove the set screws (A) from the top of the Arbor Body and the Front Support Bracket Bolts (B) from the front of the Magnet. Once these are removed the Arbor Body Assembly can be removed from the Drill Assembly.

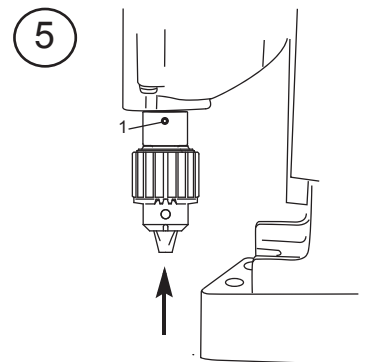
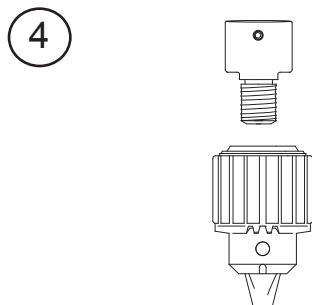

Thread the 3-Jaw Chuck onto the Spindle Adapter until tight. Now slide the complete assembly up onto the Hex Spindle at the bottom of the motor. While pushing up on the Spindle Adapter / Chuck Assembly, turn the set screw in at the top of the Adapter until tight; as shown in Fig.5.

Continued

6

40432 Stop Screw SHC 1/4-28 X 3/8
(included with the 05536 kit.)

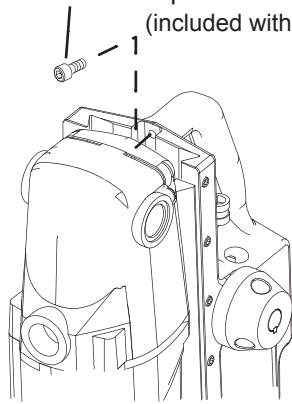

Now that the Chuck and Adapter is installed, part number 40432 Stop Screw needs to be installed. This Stop Screw could be threaded into the top of housing in front of the Motor Assembly as shown in Diagram 6.

Your 3-Jaw Chuck is now installed. Select the proper twist bit for your application and follow Operating Procedures for the Hougen Magnet Based Drill you are using.

(05536) SPINDLE ADAPTER KIT

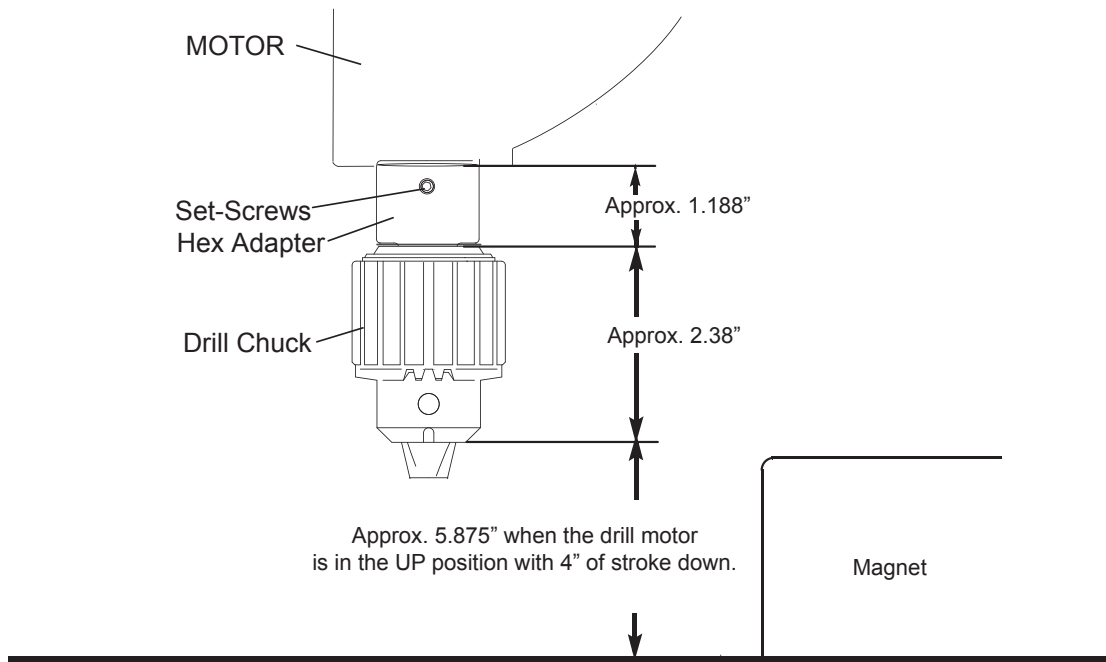

3001 HOUGEN DRIVE • SWARTZ CREEK, MI 48473
PHONE: (810) 635-7111 • FAX: (810) 635-8277
E-MAIL: INFO@HOUGEN.COM
ONLINE: WWW.HOUGEN.COM
Form 05547 0510